

VICINITY MAP
Not To Scale

CAROLINA MARINE TERMINAL TERMINAL EXPANSION

3330 RIVER ROAD WILMINGTON, NORTH CAROLINA

ISSUED FOR CONSTRUCTION RELEASE

OCTOBER 23, 2015

SHEET INDEX

SHEET #	FILE #	DESCRIPTION
G-0		COVER SHEET
G-1	CP101	OVERALL SITE INVENTORY PLAN
G-2	CP102	DOMES #8 - #10 SITE PLAN
C-1	CG101	GRADING, DRAINAGE, & EROSION CONTROL PLAN
G-2	CE501	EROSION CONTROL DETAILS
C-3	CL101	LANDSCAPE PLAN

CITY OF WILMINGTON STANDARD NOTES

- PRIOR TO ANY CLEARING, GRADING OR CONSTRUCTION ACTIVITY, TREE PROTECTION FENCING WILL BE INSTALLED AROUND PROTECTED TREES OR GROVES OF TREES AND NO CONSTRUCTION WORKERS, TOOLS, MATERIALS, OR VEHICLES ARE PERMITTED WITHIN THE TREE PROTECTION FENCING.
- ALL PAVEMENT MARKINGS IN PUBLIC RIGHTS-OF-WAY AND FOR DRIVEWAYS ARE TO BE THERMOPLASTIC AND MEET CITY AND/OR NCDOT STANDARDS.
- ONCE PUBLIC STREETS ARE OPEN TO TRAFFIC, THE DEVELOPER SHALL CONTACT TRAFFIC ENGINEERING TO REQUEST INSTALLATION OF TRAFFIC AND STREET NAME SIGNS. PROPOSED STREET NAMES MUST BE APPROVED PRIOR TO INSTALLATION OF STREET NAME SIGNS.
- TRAFFIC CONTROL DEVICES (INCLUDING SIGNS AND PAVEMENT MARKINGS) IN AREAS OPEN TO PUBLIC TRAFFIC ARE TO MEET MUTCD (MANUAL ON UNIFORM TRAFFIC CONTROL DEVICES) STANDARDS.
- ANY BROKEN OR MISSING SIDEWALK PANELS, DRIVEWAY PANELS, AND CURBING SHALL BE REPLACED.
- CONTACT TRAFFIC ENGINEERING AT (910) 341-7888 TO DISCUSS STREET LIGHTING OPTIONS.
- IF THE CONTRACTOR DESIRES WATER FOR CONSTRUCTION HE SHALL APPLY WITH THE CFPWA IN ADVANCE FOR THIS SERVICE AND MUST PROVIDE A REDUCED PRESSURE ZONE (RPZ) BACKFLOW PREVENTION DEVICE ON THE DEVELOPER'S SIDE OF THE WATER METER BOX.
- CONTACT TRAFFIC ENGINEERING AT (910) 341-7888 TO ENSURE THAT ALL TRAFFIC SIGNAL FACILITIES AND EQUIPMENT ARE SHOWN ON THE PLAN. CALL TRAFFIC ENGINEERING FORTY-EIGHT HOURS PRIOR TO ANY EXCAVATION IN THE RIGHT-OF-WAY. TRAFFIC ENGINEERING MUST APPROVE OF PAVEMENT MARKING PRIOR TO ACTUAL STRIPING.
- TACTILE WARNING MATS ARE TO BE INSTALLED ON ALL WHEELCHAIR RAMPS.
- ALL PARKING STALL MARKINGS AND LANE ARROWS WITHIN THE PARKING AREAS SHALL BE WHITE.
- ALL TRAFFIC CONTROL SIGNS AND MARKINGS OUTSIDE THE PUBLIC RIGHT-OF-WAY ARE TO BE MAINTAINED BY THE PROPERTY OWNER.
- STOP SIGNS AND STREET SIGNS TO REMAIN IN PLACE DURING CONSTRUCTION.
- A UTILITY CUT PERMIT IS REQUIRED FOR EACH OPEN CUT OF A CITY UTILITY.
- NO OBSTRUCTIONS ARE PERMITTED IN THE SPACE BETWEEN THIRTY (30) INCHES AND TEN (10) FEET ABOVE THE GROUND WITHIN THE TRIANGULAR SIGHT DISTANCE.
- PERMITTING OF BUSINESS IDENTIFICATION SIGNAGE IS A SEPARATE PROCESS. NCDOT/CITY OF WILMINGTON WILL NOT ALLOW THESE OBSTRUCTIONS WITHIN THE RIGHT-OF-WAY.

OWNER / DEVELOPER:

ALTAMAR, INC.
3330 RIVER ROAD
WILMINGTON, NC 28412

OWNER'S DESIGNATED REPRESENTATIVE:

MICHAEL MCCARLEY, PRESIDENT
ALTAMAR, INC.
mike@admci.com
(910) 395-4777

PROJECT ENGINEER / REPRESENTATIVE:

J. BRANCH SMITH, PE
McKIM & CREED, INC.
243 NORTH FRONT STREET
WILMINGTON, NORTH CAROLINA 28401
brsmith@mckimcreed.com
(910) 343-1048

PROJECT ADDRESS:

3330 RIVER ROAD
WILMINGTON, NC 28412

TAX PARCEL IDENTIFICATION NUMBER:

R06400-001-004-000

PROPERTY ZONING:

IND - INDUSTRIAL



PROJECT AERIAL
SCALE: 1" = 200'

REF. NCONE MAP AERIAL 2012

NORTH

STORMWATER MANAGEMENT PLAN
APPROVED
CITY OF WILMINGTON
ENGINEERING DEPARTMENT
DATE 11/24/15 PERMIT # 2005018123
SIGNED [Signature]

Approved Construction Plan
Name [Signature] Date 11/23/15
Planning [Signature]
Traffic [Signature]
Fire [Signature]

1 inch

For each open utility cut of City streets, a \$325 permit shall be required from the City prior to occupancy and/or project acceptance.



243 North Front Street
Wilmington, North Carolina 28401
Phone: (910)343-1048 , Fax: (910)251-8282
NC LICENSE NO. F-1222
www.mckimcreed.com

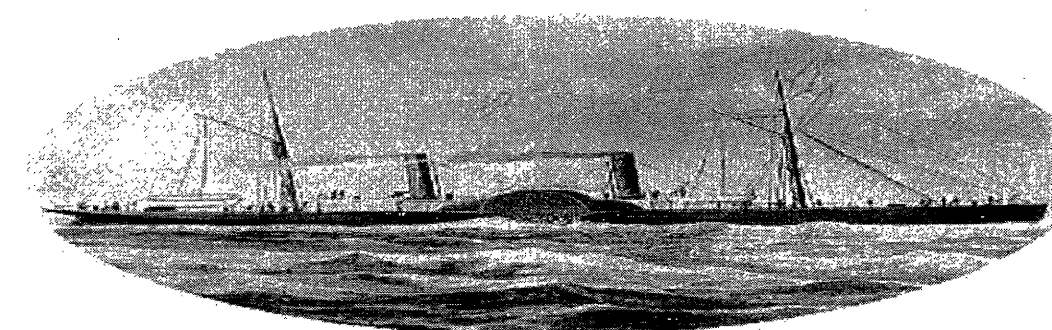

CAROLINA MARINE TERMINAL



Know what's below.
Call before you dig.



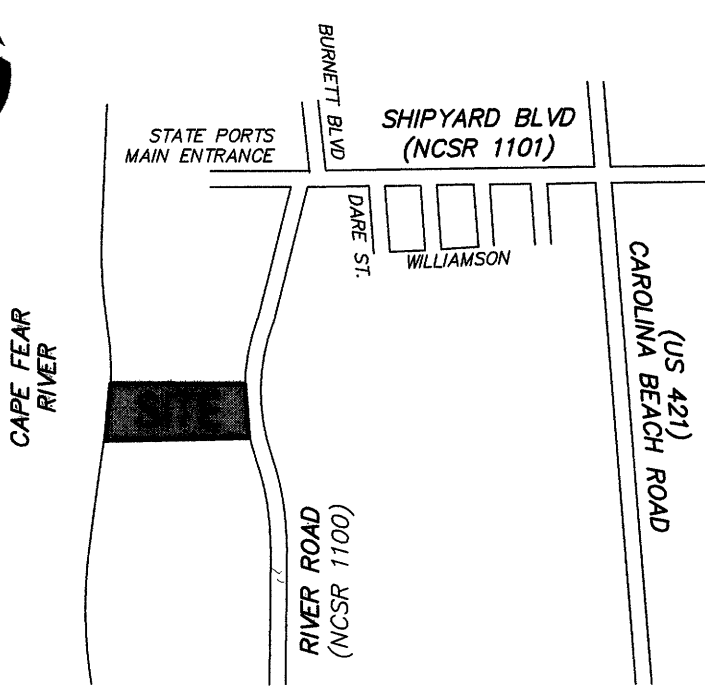

VICINITY MAP

Not To Scale

SITE INVENTORY GENERAL INFORMATION

- 1. Applicant name: ALTAMAR, INC.
2. Site address of the development: 3330 RIVER ROAD, WILMINGTON, NORTH CAROLINA
3. Property owner: ALTAMAR, INC.
4. Name of developer: CAROLINA MARINE TERMINAL, INC.
5. Property boundary. Indicate minimum Tax Parcel information or boundary survey, or deed composite: INDICATED ON THIS DRAWING / PARCEL ID R06400-001-004-000
6. Indicate the zoning of the property: PROPERTY ZONED IN D
7. Adjacent property information, including owner and zoning: OWNERS INDICATED ON THIS DRAWING, ZONING IS IN D
8. Vicinity map in relation to the site: INDICATED ON THIS DRAWING
9. Topography of the site in one (1) foot intervals: MCKIM & CREED FIELD SURVEYS (2005-2015)
10. Approximate location of 100-year flood plain boundary. Note areas with a history of flooding: INDICATED ON THIS DRAWING
11. Locate existing ditches, creeks, and streams and their classification (i.e. intermittent, perennial, C (SW), ORW, etc.): INDICATED ON THIS DRAWING; CAPE FEAR RIVER and FRESH WATER STREAM (Sc Classification)
12. Indicate the types of soils as referenced in the most recent book of Soil Survey of New Hanover County, North Carolina by the US Department of Agriculture and Natural Resource Conservation Service: URBAN LAND (Ur), DOROVAN (Do), AND TIDAL MARSH (TM).
13. Locate any CAMA areas of concern (AEC) and associated setbacks: INDICATED ON THIS DRAWING
14. Identify the CAMA land classification from the Wilmington-New Hanover County Comprehensive Plan: CONSERVATION & URBAN
15. Indicate the presence or non-presence of Conservation Resources: 100' SETBACK (CITY) AS INDICATED ON THIS DRAWING
16. Indicate whether or not the site is recognized as a local, state or federally historic or archaeological site: NONE
17. Indicate the location of cemeteries, burial sites, or burial grounds: NONE
18. Delineate aerial extent of forested areas, indicated areas in square feet or acres, and note habitat and dominant species within stands: NONE
19. Delineate the approximate location of U.S. Army Corps of Engineers Section 404 wetlands and Section 10 waters: INDICATED ON THIS DRAWING
20. Indicate the presence of protected species or habitat information available from the U.S. Fish and Wildlife Service and N.C. natural heritage inventory: NO PROTECTED SPECIES OR HABITAT ON SITE
21. Indicate the presence or non-presence of existing or proposed thoroughfares, bike routes, pedestrian sidewalks or trails and transit facilities: INDICATED ON THIS DRAWING
22. FLOOD_ZONE INFO: Property lies in ZONE 'AE' EL 9 (base flood elevation determined), ZONE 'X OTHER' (areas of 0.2% ANNUAL CHANCE FLOODPLAIN), and ZONE 'X' (areas determined to be outside the 0.2% ANNUAL CHANCE FLOODPLAIN) as scaled from FIRM MAP Number 3720311500K and 3720311600K Dated June 02, 2006. Vertical Datum is NAVD 88 (to convert from NGVD 29 to NAVD 88, subtract 0.95').
23. Plats and Documents shall be recorded to provide perpetual protections for conservation resources and associated setbacks in accordance to the City of Wilmington Code of Ordinances, Section 18-341 Conservation Resource Regulations.

STORMWATER MANAGEMENT PLAN APPROVED CITY OF WILMINGTON ENGINEERING DEPARTMENT DATE 11/21/15 PERMIT # 200501823 SIGNED [Signature]

For each open utility cut of City streets, a \$325 permit shall be required from the City prior to occupancy and/or project acceptance.

1 inch

Table with 3 columns: Category, Value, Unit. Rows include IMPERVIOUS AREA (EXISTING), IMPERVIOUS AREA (PROPOSED DOMES #8-#10), and OVERALL IMPERVIOUS.

Table with 3 columns: Category, Value, Unit. Rows include CONSERVATION RESOURCE IMPACTS, TOTAL AREA OF CAMA AEC LINE, IMPERVIOUS IMPACT IN CAMA AEC LINE, etc.

PARKING CALCULATIONS table with 2 columns: Category, Value. Rows include CURRENT USE, TOTAL SPACES, ACCESSIBLE SPACES PROVIDED.

Approved Construction Plan form with fields for Name, Date, Planning, Traffic, Fire.

POND DREGGED TO ORIGINAL DEPTHS AUGUST 2015. CONTOURS REFLECT DREGGING

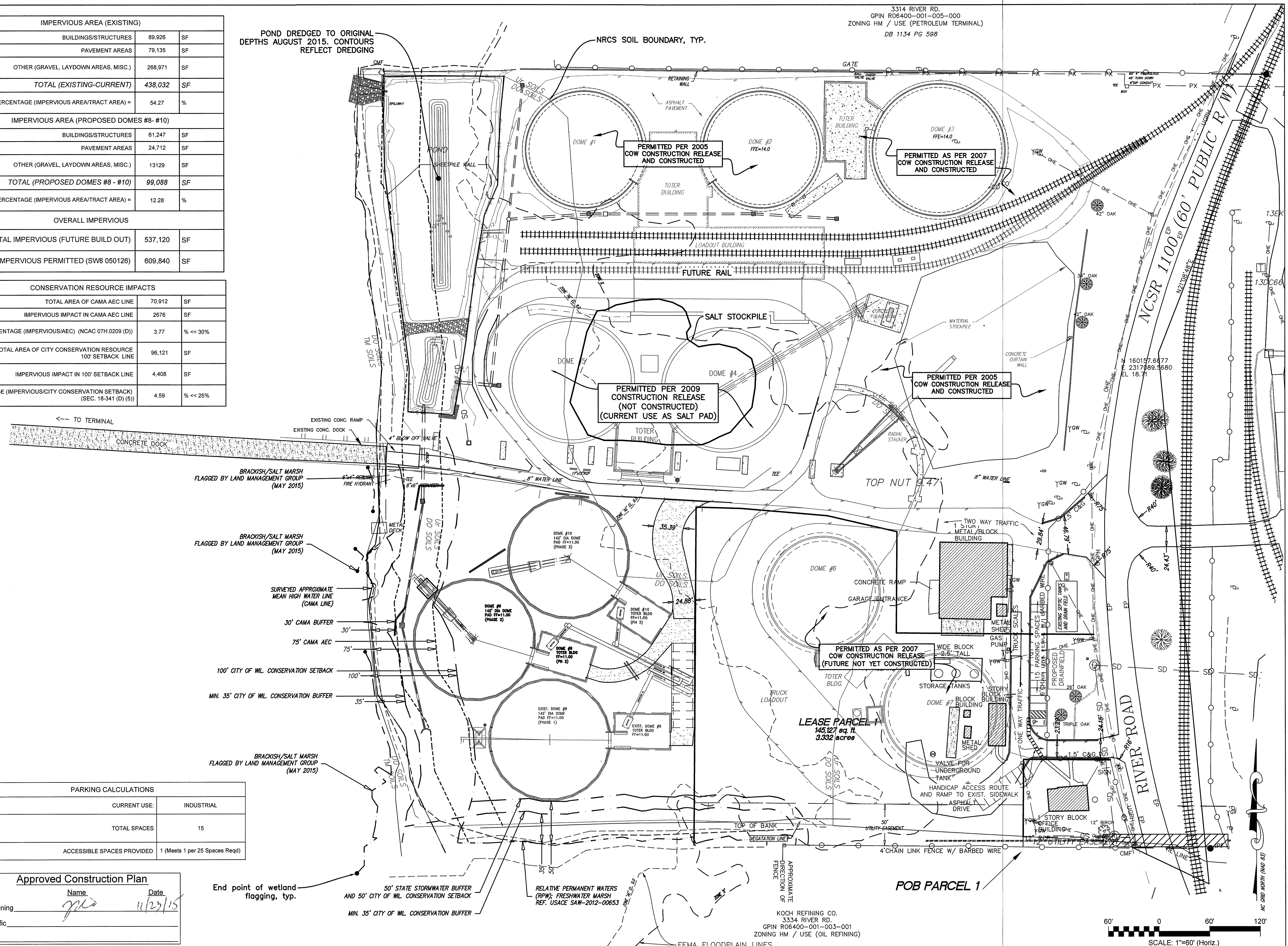

3314 RIVER RD. GPIN R06400-001-005-000 ZONING HM / USE (PETROLEUM TERMINAL) DB 1134 PG 598

KOCH REFINING CO. 3334 RIVER RD. GPIN R06400-001-003-001 ZONING HM / USE (OIL REFINING)

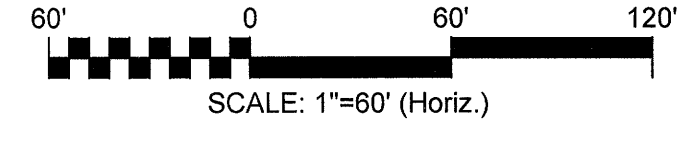

Revision table with columns: REVNO., DESCRIPTIONS, DATE.

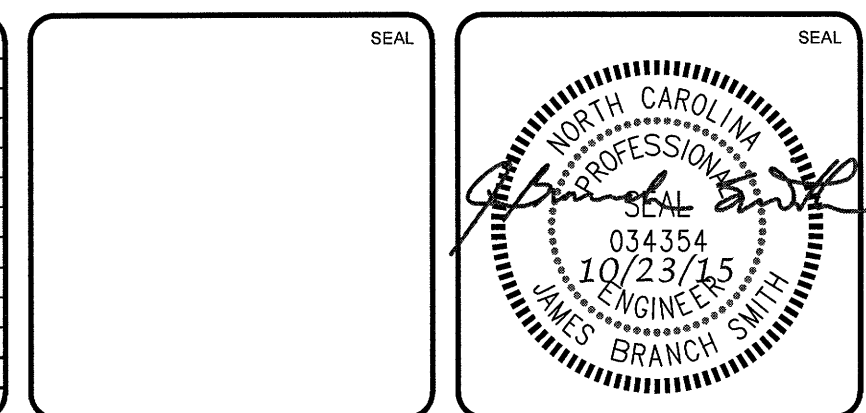

MCKIM & CREED logo and contact information: 243 North Front Street, Wilmington, North Carolina 28401.

Carolina Marine Terminal logo and address: 3330 River Road, Wilmington, NC 28412.

CAROLINA MARINE TERMINAL TERMINAL EXPANSION (2015) OVERALL SITE INVENTORY PLAN

Project metadata including Date (4/2/2015), Scale (1"=60' Horiz.), Drawing Number (CP101), and Status (RE-ISSUED FOR CONSTRUCTION).

BRACKISH/SALT MARSH
FLAGGED BY LAND MANAGEMENT GROUP
(MAY 2015)

BRACKISH/SALT MARSH
FLAGGED BY LAND MANAGEMENT GROUP
(MAY 2015)

SURVEYED APPROXIMATE
MEAN HIGH WATER LINE
(CAMA LINE)

30' CAMA BUFFER

75' CAMA AEC

100' CITY OF WL. CONSERVATION SETBACK

MIN. 35' CITY OF WL. CONSERVATION BUFFER

BRACKISH/SALT MARSH
FLAGGED BY LAND MANAGEMENT GROUP
(MAY 2015)

CONSERVATION RESOURCE IMPACTS		
TOTAL AREA OF CAMA AEC LINE	70,912	SF
IMPERVIOUS IMPACT IN CAMA AEC LINE	2876	SF
PERCENTAGE (IMPERVIOUS/AEC) (NCAC 07H.0209 (D))	3.77	% << 30%
TOTAL AREA OF CITY CONSERVATION RESOURCE 100' SETBACK LINE	96,121	SF
IMPERVIOUS IMPACT IN 100' SETBACK LINE	4,408	SF
PERCENTAGE (IMPERVIOUS/CITY CONSERVATION SETBACK) (SEC. 18-341 (D) (5))	4.59	% << 25%

50' STATE STORMWATER BUFFER
AND 50' CITY OF WL. CONSERVATION SETBACK

MIN. 35' CITY OF WL. CONSERVATION BUFFER

RELATIVE PERMANENT WATERS
(RPW); FRESHWATER MARSH
REF. USACE SAW-2012-00653

DOMES #10
142' DIA DOME
PAD FF=11.00
(PHASE 3)

DOMES #9
142' DIA DOME
PAD FF=11.00
(PHASE 2)

DOMES #9
TOTER/BLDG
FF=11.00
(PH 2)

EXIST. DOMES #8
142' DIA DOME
PAD FF=11.00
(PHASE 1)

EXIST. DOMES #8
TOTER/BLDG
FF=11.00

TRUCK
LANE
CANOPY

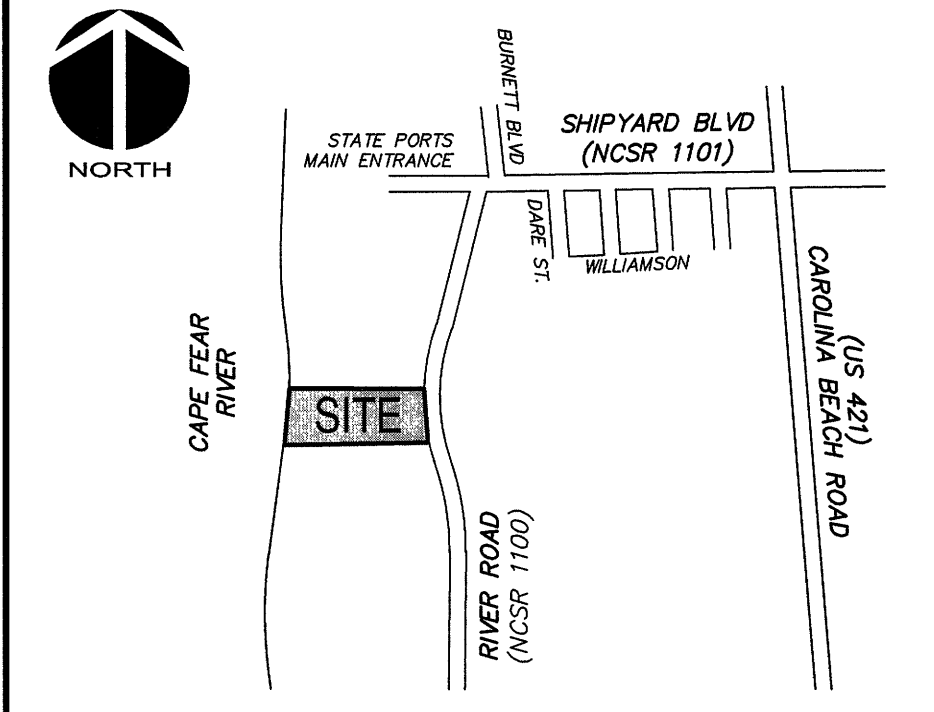

VICINITY MAP
Not To Scale

SITE INVENTORY GENERAL INFORMATION

1. Applicant name: ALTAMAR, INC.
2. Site address of the development: 3330 RIVER ROAD, WILMINGTON, NORTH CAROLINA
3. Property owner: ALTAMAR, INC.
4. Name of developer: CAROLINA MARINE TERMINAL, INC.
5. Property boundary. Indicate minimum Tax Parcel information or boundary survey, or deed composite: INDICATED ON THIS DRAWING / PARCEL ID R06400-001-004-000
6. Indicate the zoning of the property: PROPERTY ZONED IND
7. Adjacent property information, including owner and zoning: OWNERS INDICATED ON THIS DRAWING, ZONING IS IND
8. Vicinity map in relation to the site: INDICATED ON THIS DRAWING
9. Topography of the site in one (1) foot intervals: MCKIM & CREED FIELD SURVEYS (2005-2015)
10. Approximate location of 100-year flood plain boundary. Note areas with a history of flooding: INDICATED ON THIS DRAWING
11. Locate existing ditches, creeks, and streams and their classification (i.e. intermittent, perennial, C (SW), ORW, etc): INDICATED ON THIS DRAWING; CAPE FEAR RIVER and FRESH WATER STREAM (Sc Classification)
12. Indicate the types of soils as referenced in the most recent book of Soil Survey of New Hanover County, North Carolina by the US Department of Agriculture and Natural Resource Conservation Service: URBAN LAND (Ur), DOROVAN (Do), AND TIDAL MARSH (Tm).
13. Locate any CAMA areas of concern (AEC) and associated setbacks: INDICATED ON THIS DRAWING
14. Identify the CAMA land classification from the Wilmington-New Hanover County Comprehensive Plan: CONSERVATION & URBAN
15. Indicate the presence or non-presence of Conservation Resources: CITY OF WL. SETBACKS (CITY) AS INDICATED.
16. Indicate whether or not the site is recognized as a local, state or federally historic or archaeological site: NONE
17. Indicate the location of cemeteries, burial sites, or burial grounds: NONE
18. Delineate aerial extent of forested areas, indicated areas in square feet or acres, and note habitat and dominant species within stands: NONE
19. Delineate the approximate location of U.S. Army Corps of Engineers Section 404 wetlands and Section 10 waters: INDICATED ON THIS DRAWING
20. Indicate the presence of protected species or habitat information available from the U.S. Fish and Wildlife Service and N.C. natural heritage inventory: NO PROTECTED SPECIES OR HABITAT ON SITE
21. Indicate the presence or non-presence of existing or proposed thoroughfares, bike routes, pedestrian sidewalks or trails and transit facilities: INDICATED ON THIS DRAWING
22. FLOOD ZONE INFO: Property lies in ZONE "AE" EL 9 (base flood elevation determined), ZONE "X OTHER" (areas of 0.2% ANNUAL CHANCE FLOODPLAIN), and ZONE "X" (areas determined to be outside the 0.2% ANNUAL CHANCE FLOODPLAIN) as scaled from FIRM MAP Number 3720311500K and 3720311600K Dated June 02, 2006. Vertical Datum is NAVD 88 (to convert from NGVD 29 to NAVD 88, subtract 0.95').
23. Plats and Documents shall be recorded to provide perpetual protections for conservation resources and associated setbacks in accordance to the City of Wilmington Code of Ordinances, Section 18-341 Conservation Resource Regulations.

For each open utility cut of
City streets, a \$325 permit
shall be required from the
City prior to occupancy
and/or project acceptance.

STORMWATER MANAGEMENT PLAN
APPROVED
CITY OF WILMINGTON
ENGINEERING DEPARTMENT
DATE 11/23/15 PERMIT # 200501823
SIGNED [Signature]

Approved Construction Plan

Name	Date
gms	11/23/15
Planning	
Traffic	
Fire	

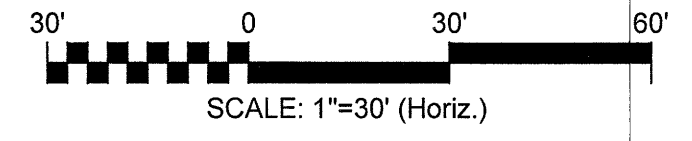

REVNO.	DESCRIPTIONS	DATE
F	ISSUED FOR TRC AND DESIGN BY PLAN REVISION	10/23/15
E	ISSUED FOR TRC CONSTRUCTION RELEASE	09/15/15
D	TRC SUBMITTAL No. 3	09/03/15
C	TRC SUBMITTAL No. 2	05/18/15
B	ISSUED FOR COW TRC	4/29/15
A	ISSUED FOR CAMA MINOR MODIFICATION REVIEW	4/22/15

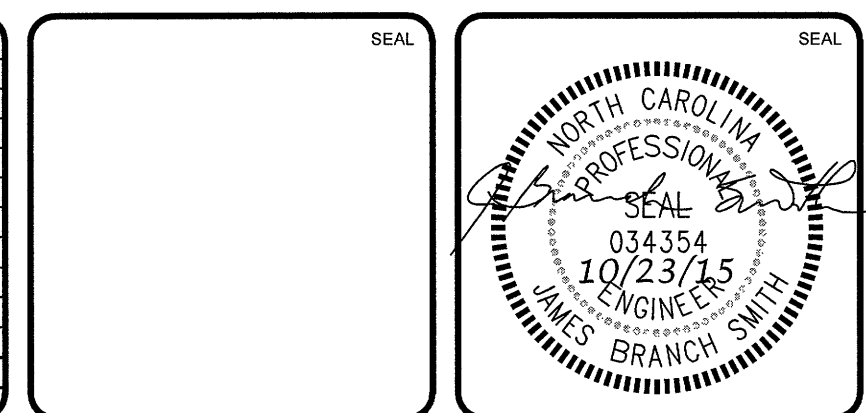

MCKIM & CREED

243 North Front Street
Wilmington, North Carolina 28401
Phone: (910)343-1048, Fax: (910)251-8282
License: F-1222
www.mckimcreed.com

Carolina Marine Terminal
3330 River Road
Wilmington, NC 28412

CAROLINA MARINE TERMINAL
TERMINAL EXPANSION (2015)
Wilmington, NC

DOMES #8 - #10 SITE PLAN

DATE:	4/2/2015	SCALE:	1"=30'	M&C FILE NUMBER:	CP102
M&C PROJ. #:	3057-0014	HORIZONTAL:	1"=30'	DRAWING NUMBER:	G-2
DRAWN:	JBS	VERTICAL:	NA		3 of 6
DESIGNED:	JBS				
CHECKED:	RMC				
PROJ. MGR.:	RMC				
STATUS:	RE-ISSUED FOR CONSTRUCTION	REVISION:	G		

EROSION CONTROL NOTES

1. CLEAR AND REMOVE FROM SITE ALL TREES, SHRUBS, ROOTS, ROOT MAT, ETC. FROM THE AREA WITHIN DESIGNATED CLEARING LIMITS. DO NOT DISTURB INSIDE TREE PROTECTION FENCING.
2. CONTRACTOR SHALL BE RESPONSIBLE FOR CLEANING AND RESTORING TO PRE-CONSTRUCTION CONDITIONS ANY AREAS OUTSIDE THE PROJECT LIMITS THAT MAY INADVERTENTLY BE DAMAGED DUE TO THE FAILURE OF THE EROSION MEASURES DURING GRADING AND AFTER GRADING HAS BEEN COMPLETED.
3. CONTRACTOR SHALL CONTINUE TO MAINTAIN PERMANENT AND TEMPORARY EROSION CONTROL MEASURES UNTIL FINAL INSPECTION AND APPROVAL BY THE ENGINEER OR NEW HANOVER COUNTY INSPECTOR, IF REQUIRED.
4. PRIOR TO ANY CLEARING, GRADING OR CONSTRUCTION ACTIVITY, TREE PROTECTION FENCING SHALL BE INSTALLED AROUND PROTECTED TREES OR GROVES OF TREES AND NO TOOLS, STOCKPILES, MATERIALS, OR VEHICLES ARE PERMITTED WITHIN THE TREE PROTECTION FENCING.
5. IF THE SAME PERSON CONDUCTS THE LAND-DISTURBING ACTIVITY & ANY RELATED BORROW OR WASTE ACTIVITY, THE BORROW OR WASTE ACTIVITY SHALL CONSTITUTE PART OF THE LAND-DISTURBING ACTIVITY UNLESS THE BORROW OR WASTE ACTIVITY IS REGULATED UNDER THE MINING ACT OF 1971, OR IS A LANDFILL REGULATED BY THE DIVISION OF WASTE MANAGEMENT. IF THE LAND-DISTURBING ACTIVITY AND ANY RELATED BORROW OR WASTE ACTIVITY ARE NOT CONDUCTED BY THE SAME PERSON, THEY SHALL BE CONSIDERED SEPARATE LAND-DISTURBING ACTIVITIES AND MUST BE PERMITTED EITHER THROUGH THE SEDIMENTATION POLLUTION CONTROL ACT AS A ONE-USE BORROW SITE OR THROUGH THE MINING ACT.
6. CONTACT PERSON SHOULD ISSUES ARISE DURING EROSION AND SEDIMENT CONTROL OPERATION:
ANDY TOMLIN @ 910-395-4777

TEMPORARY INLET PROTECTION DANDY SACK® OR APPROVED EQUAL OR HARDWARE CLOTH & GRAVEL INLET PROTECTION (TYP.) SEE DETAILS, CE501.

ALL IMPERVIOUS AREAS SHALL BE DIRECTED INTO THE SWALE, GRATE INLETS, OR DIRECTLY INTO THE WET POND FOR STORMWATER MANAGEMENT ON THIS TRACT.

PERMANENT VEGETATION IS A STANDARD CITY OF WILMINGTON PERMIT CONDITION PRIOR TO USE. SEEDING AND OR SOD MUST BE ESTABLISHED WELL BEFORE THE CONSTRUCTION ENDS.

NPDES PERMIT NCG 010000 PLAN NOTES:

1. ACCORDING TO NPDES NCG 010000 EFFECTIVE AUGUST 3, 2011: THE PLANS SHALL CONFORM TO GROUND STABILIZATION REQUIREMENTS OF SECTION II.B.2 GROUND STABILIZATION.
2. ACCORDING TO NPDES NCG 010000 EFFECTIVE AUGUST 3, 2011: THE SEDIMENT BASINS SHALL CONFORM TO SURFACE WITHDRAWAL REQUIREMENTS OF SECTION II.B.4 SEDIMENT BASINS.

GROUND STABILIZATION CRITERIA

SITE AREA DESCRIPTION	STABILIZATION TIMEFRAME	STABILIZATION TIMEFRAME EXCEPTIONS
PERIMETER DIKES, SWALES, DITCHES AND SLOPES	7 DAYS	NONE
HIGH QUALITY WATER ZONES	7 DAYS	NONE
SLOPES STEEPER THAN 3:1	7 DAYS	IF SLOPES ARE 10 FT OR LESS IN LENGTH AND ARE NOT STEEPER THAN 2:1, 14 DAYS ARE ALLOWED
SLOPES 3:1 OR FLATTER	14 DAYS	7 DAYS FOR SLOPES GREATER THAN 50 FT IN LENGTH
ALL OTHER AREAS WITH SLOPES FLATTER THAN 4:1	14 DAYS	NONE (EXCEPT FOR PERIMETERS AND HOW ZONES)

REVNO	DESCRIPTIONS	DATE
F	ISSUED FOR TRC AND DENR SW PLAN REVISION	10/23/15
E	ISSUED FOR TRC CONSTRUCTION RELEASE	09/15/15
D	TRC SUBMITTAL No. 3	08/03/15
C	TRC SUBMITTAL No. 2	06/19/15
B	ISSUED FOR COW TRC	02/25/15
A	ISSUED FOR CMAA MINOR MODIFICATION REVIEW	02/25/15

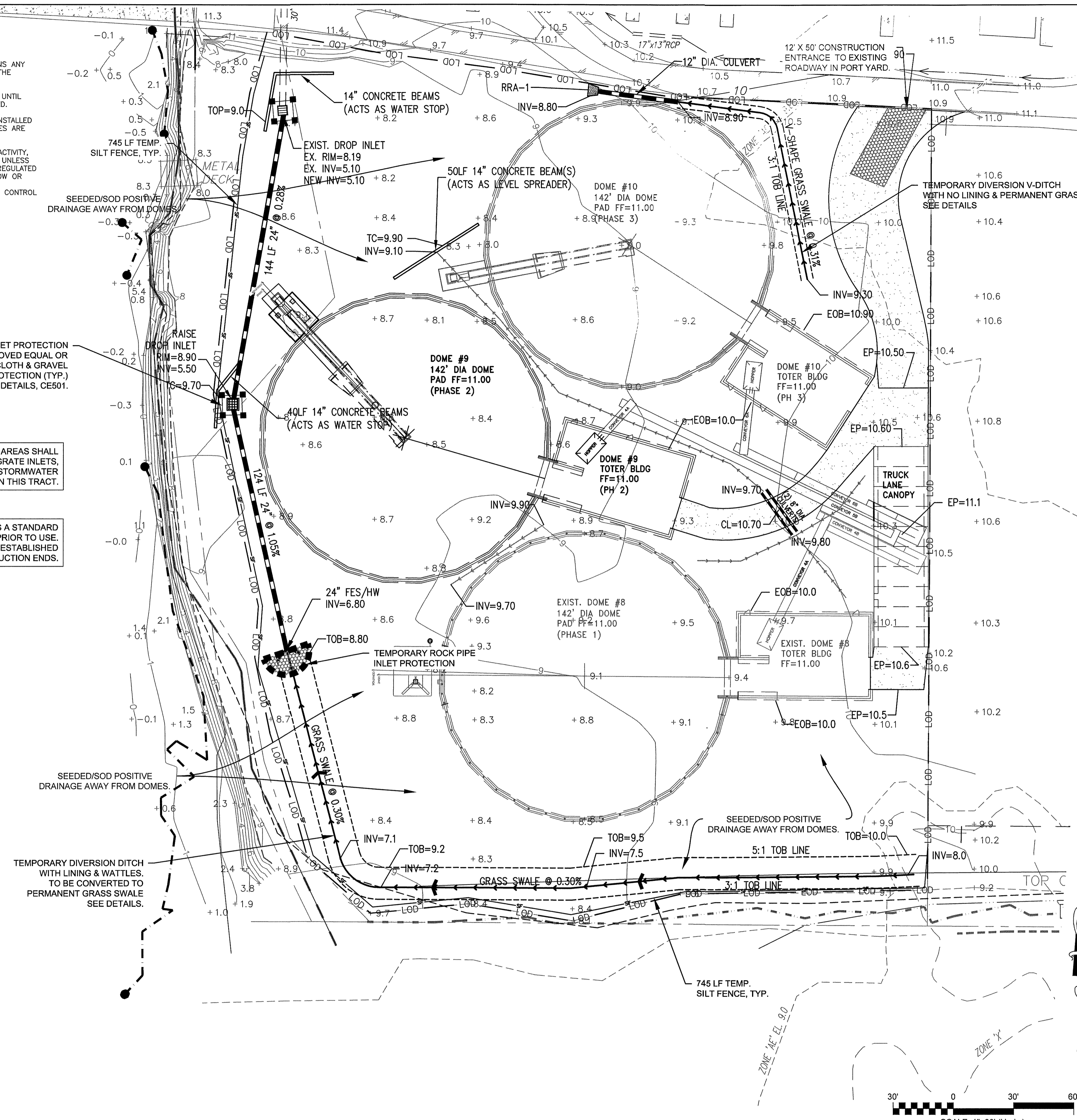

LIMITS OF DISTURBANCE = 3.27 AC

STAGE 1 & 2 CONSTRUCTION SEQUENCE

1. ESTABLISH LIMITS OF DISTURBANCE AS SHOWN.
2. A PRECONSTRUCTION CONFERENCE MUST BE HELD 48 HOURS PRIOR TO THE START OF ANY CONSTRUCTION ACTIVITIES. THE EROSION CONTROL INSPECTOR, ENGINEER, AND CONTRACTOR SHALL MEET AT THE NEW HANOVER COUNTY EROSION CONTROL INSPECTOR'S OFFICE.
3. INSTALL TEMPORARY GRAVEL CONSTRUCTION ENTRANCE AS SHOWN. CONTRACTOR SHALL MAINTAIN A SUFFICIENT GRAVEL ENTRANCE UNTIL FINAL SUBGRADE IS ESTABLISHED. IF DIRT/MUD GETS ON THE STREET, THEN A WASH RACK WILL NEED TO BE INSTALLED.
4. INSTALL SILT FENCING AS NOTED ON PLANS BEFORE COMMENCING ANY LAND DISTURBANCE ACTIVITY.
5. INSTALL INLET PROTECTION AS SHOWN ON PLANS.
6. COMMENCE GRUBBING AND ROUGH GRADING WITHIN THE LIMITS OF CONSTRUCTION.
7. COMMENCE NEW STORM PIPE INSTALLATION.
8. COORDINATE DISCONNECTION OF EXISTING UTILITIES WITH THE PROPER AUTHORITIES.
9. PROVIDE TEMPORARY STABILIZATION AND SEEDING AS NECESSARY TO PREVENT EROSION. REFER TO SHEET CE501 FOR GROUND STABILIZATION CRITERIA AND SEEDING SCHEDULE.
10. REMOVE ACCUMULATED SEDIMENT FROM SEDIMENT CONTROL MEASURES AS REQUIRED ON THE PLANS AND PERMIT.
11. CONSTRUCT TANK PADS AND OTHER STRUCTURAL SUBGRADES AND FOUNDATIONS.
12. CONTRACTOR SHALL CONTINUOUSLY MAINTAIN EROSION CONTROL MEASURES AND CLEAN AND REPAIR TEMPORARY SEDIMENT MEASURES TO MEET NEW HANOVER COUNTY APPROVAL.
13. UPON COMPLETION OF CONSTRUCTION, CONTRACTOR TO REQUEST FINAL INSPECTION FROM NEW HANOVER COUNTY EROSION CONTROL INSPECTOR TO ALLOW REMOVAL OF ALL TEMPORARY EROSION CONTROL DEVICES.
14. INSTALL LANDSCAPING AND ESTABLISH FINAL GRADES.
15. INSTALL PERMANENT SEEDING. REFER TO GROUND STABILIZATION CRITERIA TABLE FOR AREAS THAT REQUIRE 7-DAY STABILIZATION. ALL OTHER AREAS NOT REQUIRING 7-DAY STABILIZATION SHALL BE STABILIZED WITHIN 14-DAYS.
16. REMOVE ALL SEDIMENT FROM ALL STORM DRAIN PIPES.
17. SILT FENCE MUST REMAIN INSTALLED AND FUNCTIONING PROPERLY UNTIL THE LIMITS OF CONSTRUCTION HAVE BEEN PERMANENTLY STABILIZED.

LEGEND

TOB	= TOP OF BANK	●	= SANITARY SEWER MANHOLE
EP	= EDGE OF PAVEMENT	○	= POWER POLE
CL	= CENTERLINE	Y	= GUY WIRE
EOB	= EDGE OF BUILDING AT NATURAL GRADE	□	= CABLE PEDESTAL
△ RBC	= REBAR & CAP	⊕	= TELEPHONE PEDESTAL
● IPF	= IRON PIPE FOUND	⊕	= TELEPHONE MANHOLE
INV.	= INVERT	⊕	= GAS VALVE
EL.	= ELEVATION	⊕	= ASPHALT PAVEMENT
⊕	= WELL	⊕	= TEMP. ROCK PIPE INLET PROTECTION
⊕	= WATER METER	⊕	= TEMPORARY INLET PROTECTION
⊕	= FIRE HYDRANT	⊕	= STORM DRAIN MANHOLE
⊕	= WATER VALVE	---	= LIMITS OF DISTURBANCE LINE
⊕	= GRATED INLET	---	= SILT FENCE LINE
⊕	= YARD INLET	---	= UNDERGROUND STORM LINE
⊕	= STORM DRAIN MANHOLE	---	= UNDERGROUND SANITARY LINE
---	= LOD	---	= UNDERGROUND WATER LINE

For each open utility cut of City streets, a \$325 permit shall be required from the City prior to occupancy and/or project acceptance.

STORMWATER MANAGEMENT PLAN APPROVED
CITY OF WILMINGTON
ENGINEERING DEPARTMENT
DATE 11/23/15 PERMIT # 20050828
SIGNED [Signature]

Approved Construction Plan
Name: [Signature] Date: 11/23/15
Planning: [Signature]
Traffic: [Signature]
Fire: [Signature]

1 inch

SCALE: 1"=30' (Horiz.)

S:\307020\A\A\Drawings\CC - Canal Drain-ESC Plan.dwg, 10/23/2015, 4:20:50 PM, B.rhath

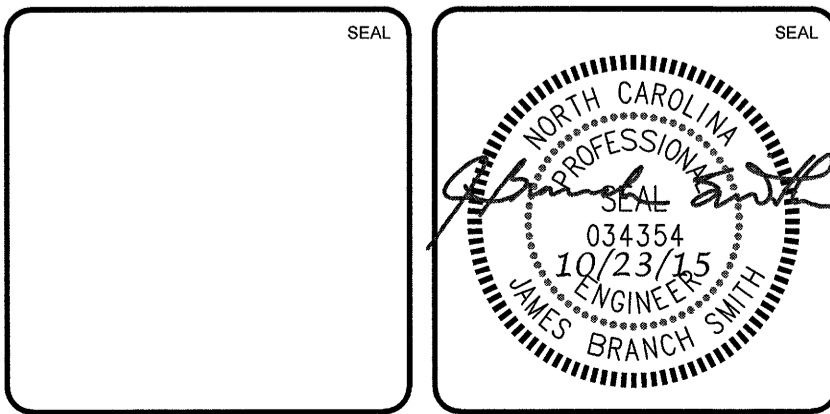

MCKIM & CREED
243 North Front Street
Wilmington, North Carolina 28401
Phone: (910)343-1048, Fax: (910)251-8282
License: F-1222
www.mckimcreed.com

Carolina Marine Terminal
3330 River Road
Wilmington, NC 28412

CAROLINA MARINE TERMINAL
TERMINAL EXPANSION (2015)
Wilmington, NC
GRADING, DRAINAGE, & EROSION CONTROL PLAN

DATE: 4/2/2015	SCALE: HORIZONTAL: 1"=30'	MCFE NUMBER: CG101
MCE PROJ.#: 3057-0014	VERTICAL: NA	DRAWING NUMBER: C-1
DRAWN: JBS		4 of 6
DESIGNED: JBS		
CHECKED: RMC		
PROJ. MGR.: RMC		
STATUS: RE-ISSUED FOR CONSTRUCTION		REVISION: G